

**1**

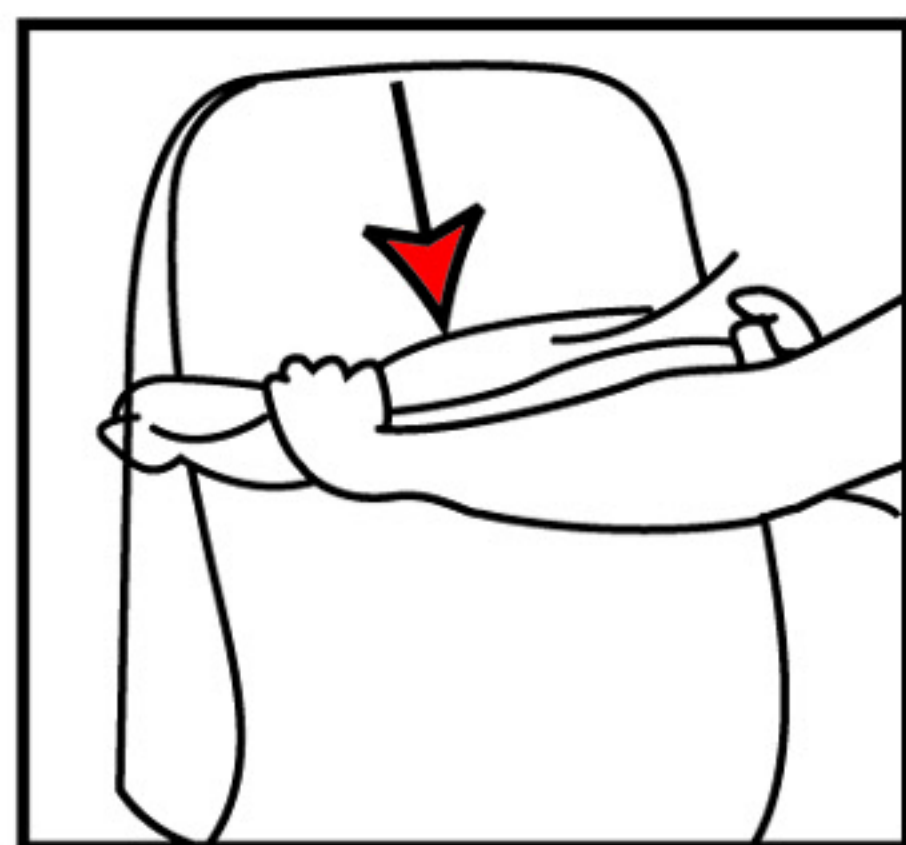

Coloque a capa por cima do encosto do assento e puxe; ajuste e estique para adequar.

**5**

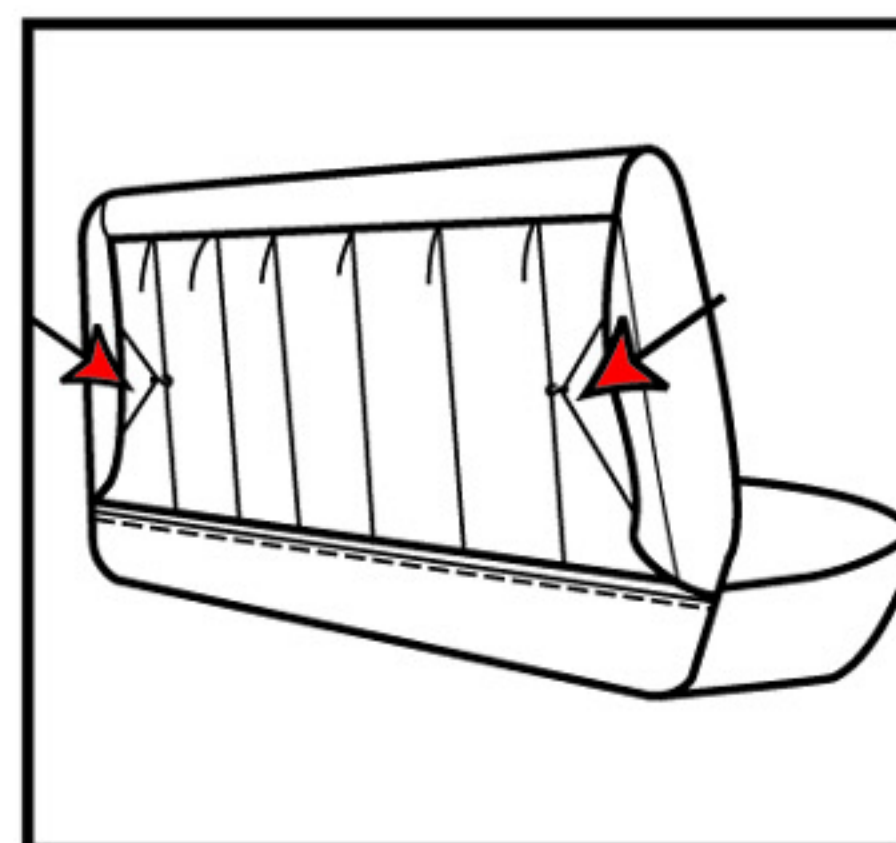

Verifique-se a capa do assento está alinhado corretamente antes de fixar.

**2**

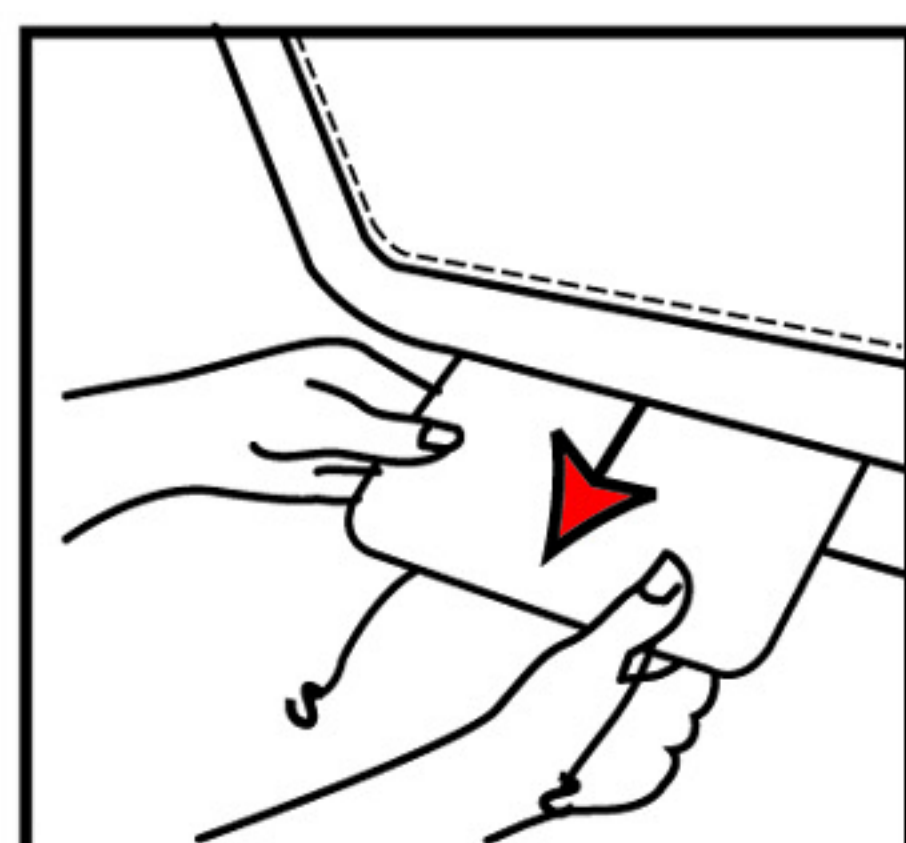

Puxe a sobra através da fenda assento.

**6**

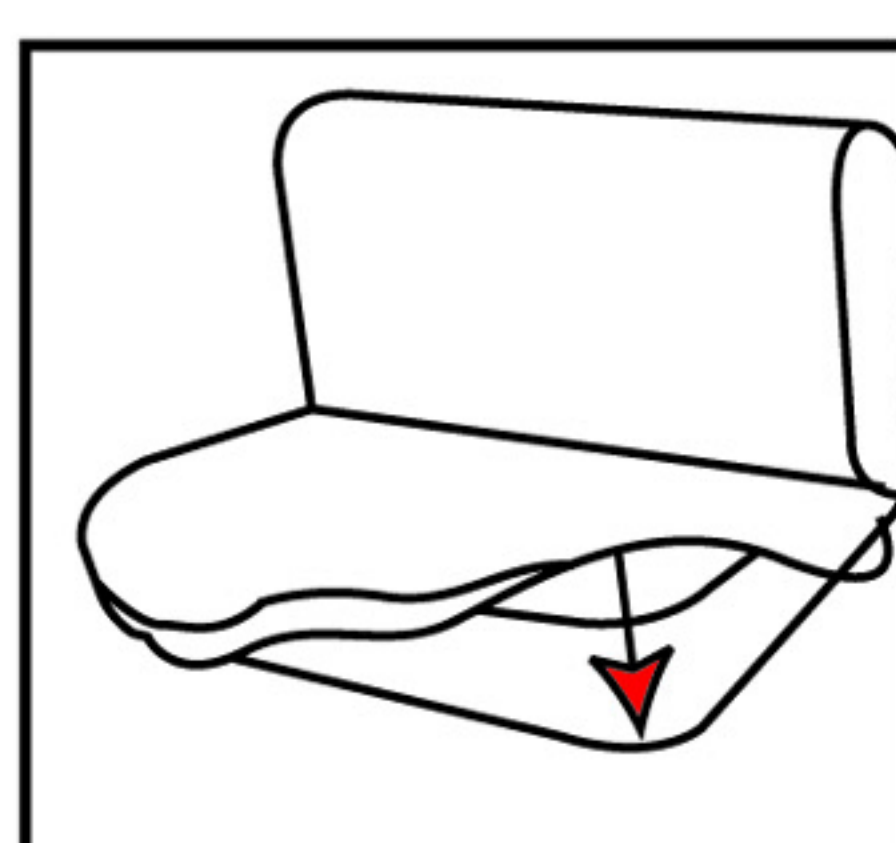

Fixe a capa no encosto do assento traseiro. Prenda as cordinhas, conforme ilustrado.

**3**

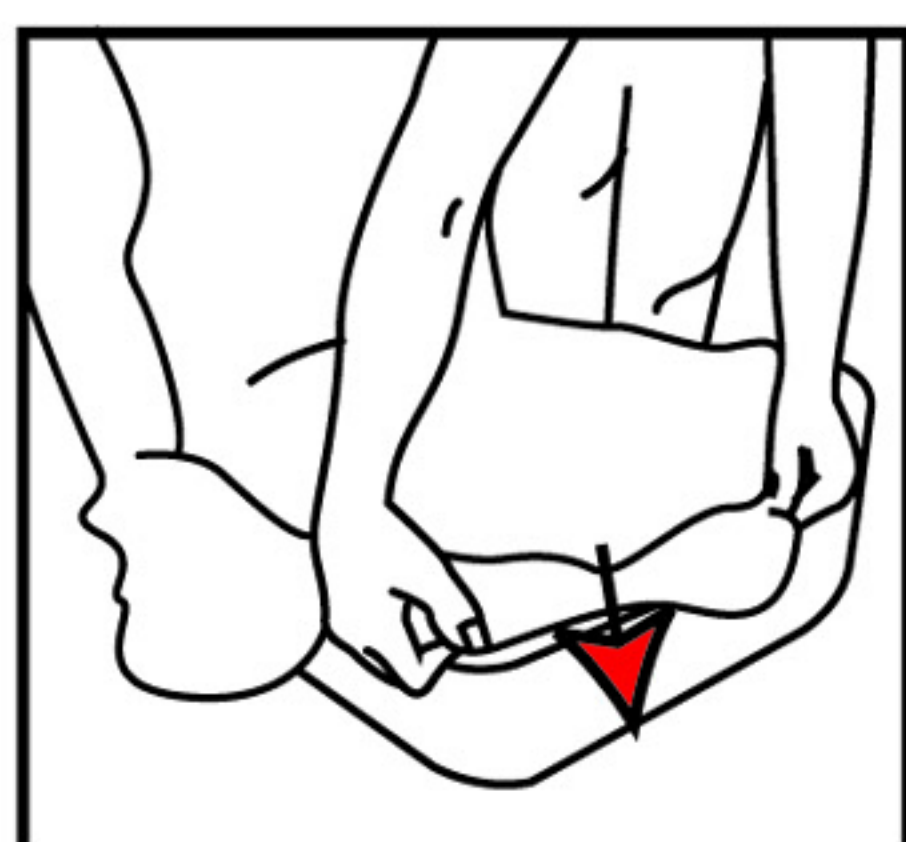

coloque a parte inferior da capa ao longo do assento dianteiro.

**7**

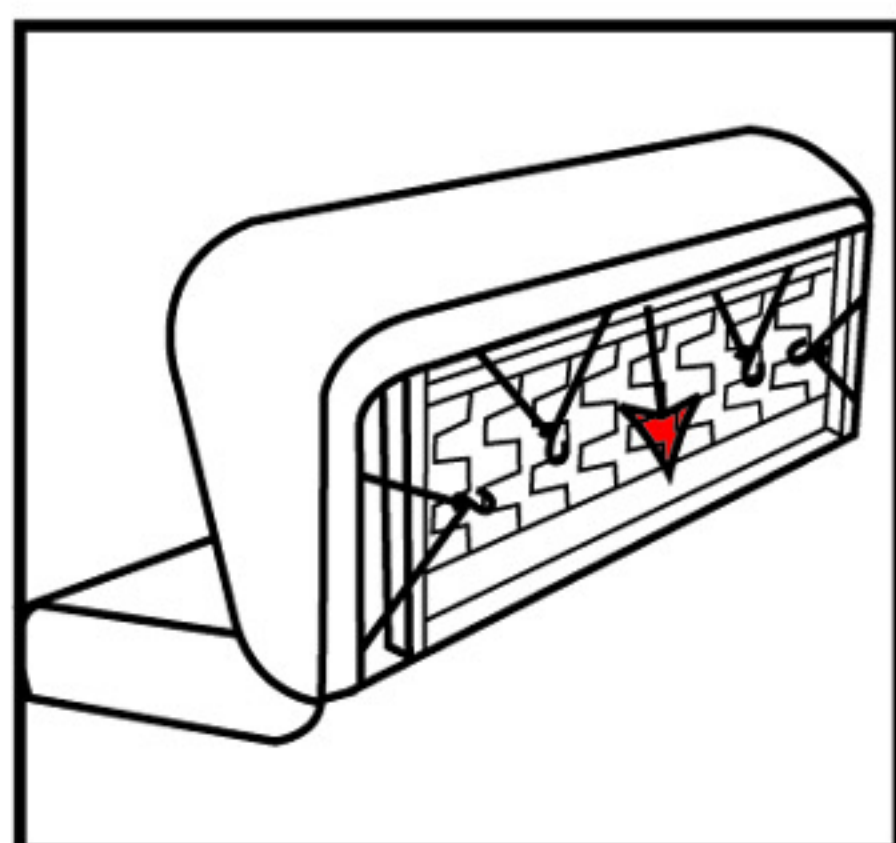

Prenda a capa na parte inferior do assento traseiro com laço e elástico na borda, conforme ilustrado.

**4**

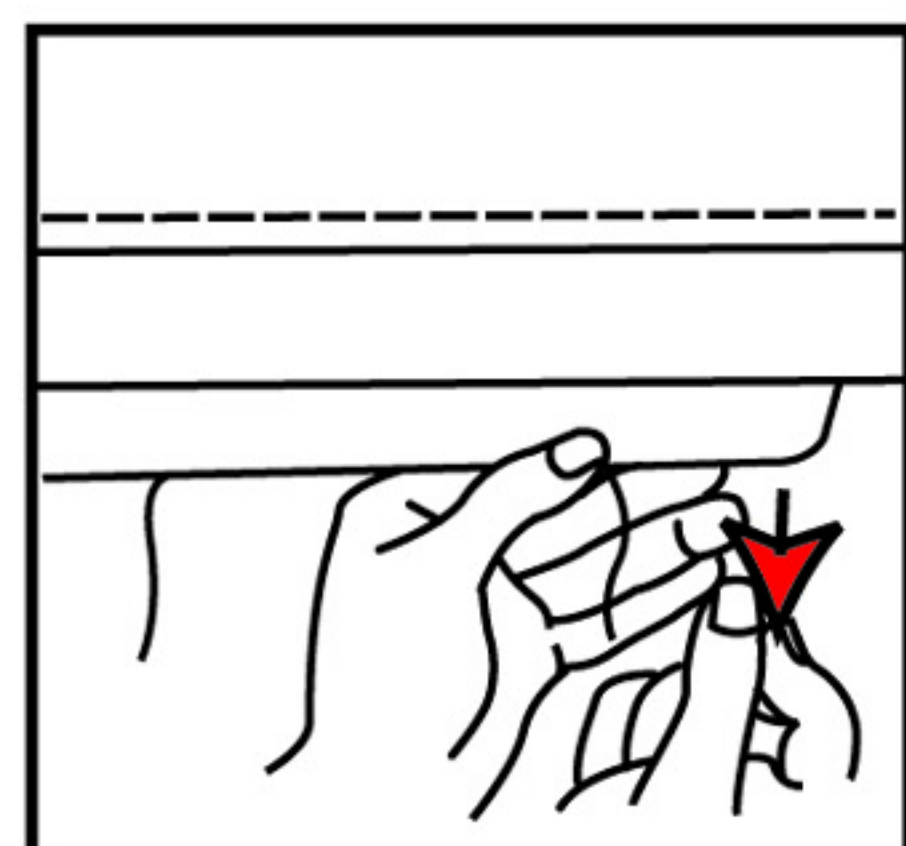

Prenda firmemente na parte de trás do assento, com os ganchos e cintas elásticas, com cuidado para adequar.

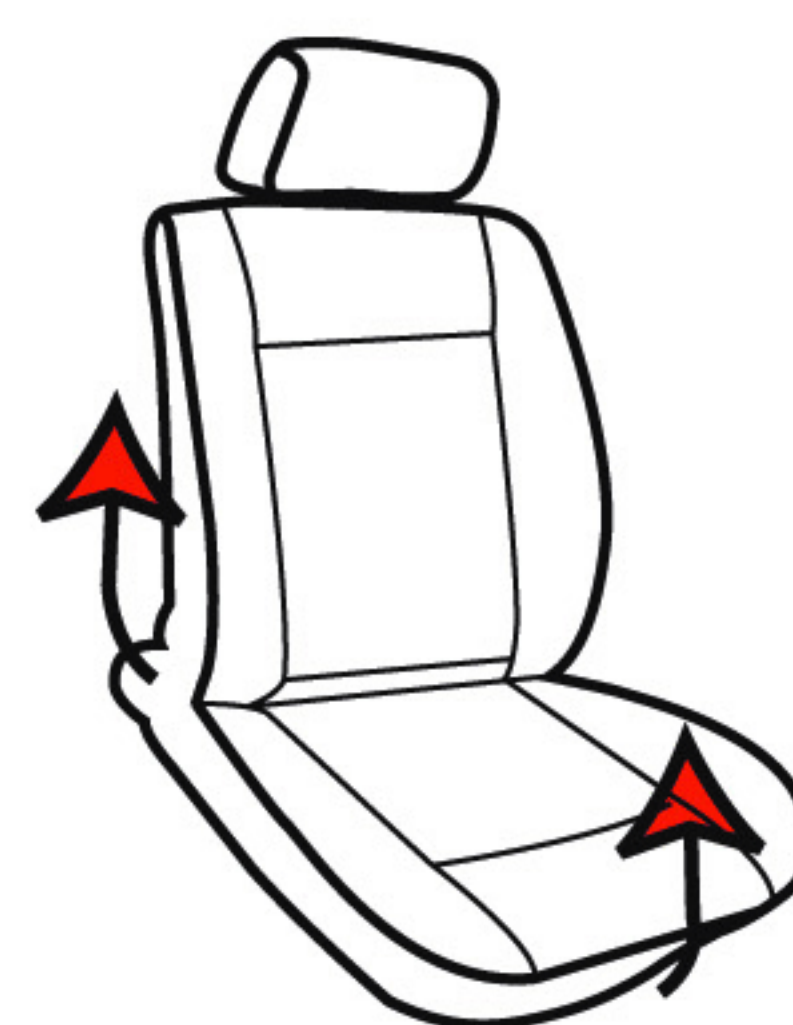

Ajusta facilmente sobre o revestimento existente de seus assentos.